

**CITY OF PORT TOWNSEND
NOTICE OF LAND USE APPLICATION
CRITICAL AREA PERMIT FILE NO. LUP23-044**

Proposal: Type II Critical Area Permit Review for Wetland/Wetland Buffer Restoration

Description: Restore unauthorized alterations to the wetland and wetland buffer using a Peninsula Environmental Group wetland planting plan: plant 197 native plants and disperse native grass and forb seed over the 455 square feet within the wetland and 3,100 square feet within the wetland buffer. As the soil was compacted due to heavy machinery, it is to be first prepared and amended.

Owners: Gage and Amy Pacifera. **Applicant:** Greg Barron, Owner of Moving Earth

Location: The property is between Sheridan Street and Cleveland Street, Weymouth & Dyer Addition Block 1 Lots 5, 6, 11 and 12. APN 931-700-111 and 931-700-103

Dates: Application: August 9, 2023
Determined Complete: September 6, 2023
Notice of Application: September 8, 2023

Other Permits to the Extent Known by the City: Critical Area Permit LUP22-064, Building Permit BLD22-253, Street Development Permit SDP22-070

Special studies and plans submitted with these applications include a site construction plan, wetland delineation plan, wetland planting plan, and engineered stormwater plan.

Location of Documents Available for Review: Planning & Community Development Dept.
250 Madison Street, Suite 3, Port Townsend, WA 98368 **Or on line at:**
<https://cityofpt.us/development-services/page/land-use-projects-under-review>

Contact: Suzanne Wassmer, Associate Planner (360) 385-0644
swassmer@cityofpt.us

Comment Period Deadline: **Thursday September 28, 2023**

The proposal is exempt from environmental review and threshold determination under the State Environmental Policy Act. Any person has the right to submit comments, request a copy of the application and the decision once made, and appeal the Director's decision. Unless appealed, there is no public hearing for this project. Written comments must be received by Planning & Community Development Department no later than 4:00 p.m. **Thursday September 28, 2023**. A statement of project consistency with the Port Townsend Comprehensive Plan and all applicable provisions of the City's Municipal Code (PTMC) Zoning (PTMC Title 17) and Critical Areas (PTMC 19.05) will be made following review of the application. A final decision on the application will be made within 120 days of the date of the Determination of Completeness.

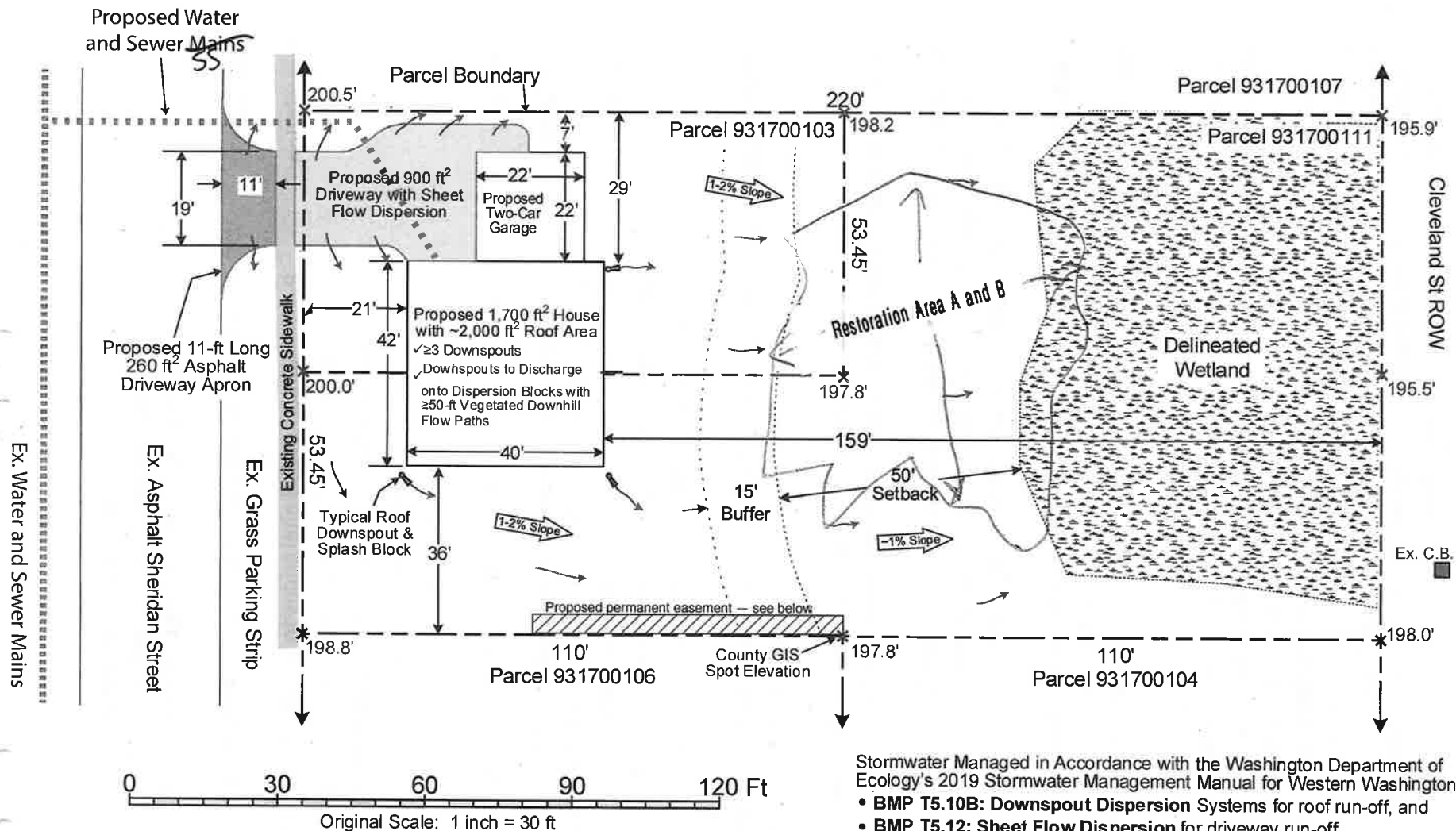

Site Plan

Pacifera / NKA Sheridan

Port Townsend WA 98368

County Parcels 931700103 & 931700111

Weymouth & Dyer Add Blk 1 Lots 5, 6, 11, 12

Total Land Area: 0.54 Acres (23,518 SF)



Proposed permanent easement with neighbor described as:

"The Eastern Sixty-seven (67) feet of the Southern three (3) feet of Lot 5 in Block 1 of Weymouth & Dyer Addition to the City of Port Townsend, as per plat recorded in Volume 1 of Plats, page 69, records of Jefferson County, Washington"

Design based on original drawings from Everett A. Sorenson, P.E.

Document last updated: October 12, 2022

RECEIVED

OCT 12 2022

CITY OF PORT TOWNSEND